



Gensler

Imagining your new
Wellness & Aquatic Complex

PROJECT TIMELINE

April 2013: Vision 2025 Master Plan adopted by Governing Board

September 2013: Feasibility Study accepted by Governing Board

January – October 2014: Programming workshops with Faculty and end Users

March 2014 : Presentation of Programming and Project at Community Forum

Summer 2014: Third-Party Fitness club consultant prepares business analysis

August 13, 2014 : Approval of program by Governing board

September 24, 2014: IFC

October 7, 2014 : HESAT Faculty and Staff

October 8, 2014: Proposition R Update at Governing Board

October 15, 2014 : Special SCC Meeting

October 28, 2014: Academic Senate

October 30, 2014 : Community Forum

November 12, 2014 : Governing Board

PROCESS / ENGAGEMENT / FEEDBACK

... Site Design Considerations:

- Universal design approach to access
- Relationship to existing campus and to future development
- Parking
- Infrastructure

... Program for Various Users

- Students
- Student athletes
- Community-based membership
- Public events

... Merge with Campus Context

- Texture
- Scale
- Materials
- Color
- Pattern

... Responsible Landscape:

- Drought tolerant
- Regionally appropriate
- Potentially part of an interpretive program

... Sustainable Principles:

- Water use reduction
- Energy conservation
- Rain water harvesting

Architectural Design

How do we propose to integrate all of these concerns into a inspired design response that is program-driven, sustainable, financially responsible, memorable, and place-making?

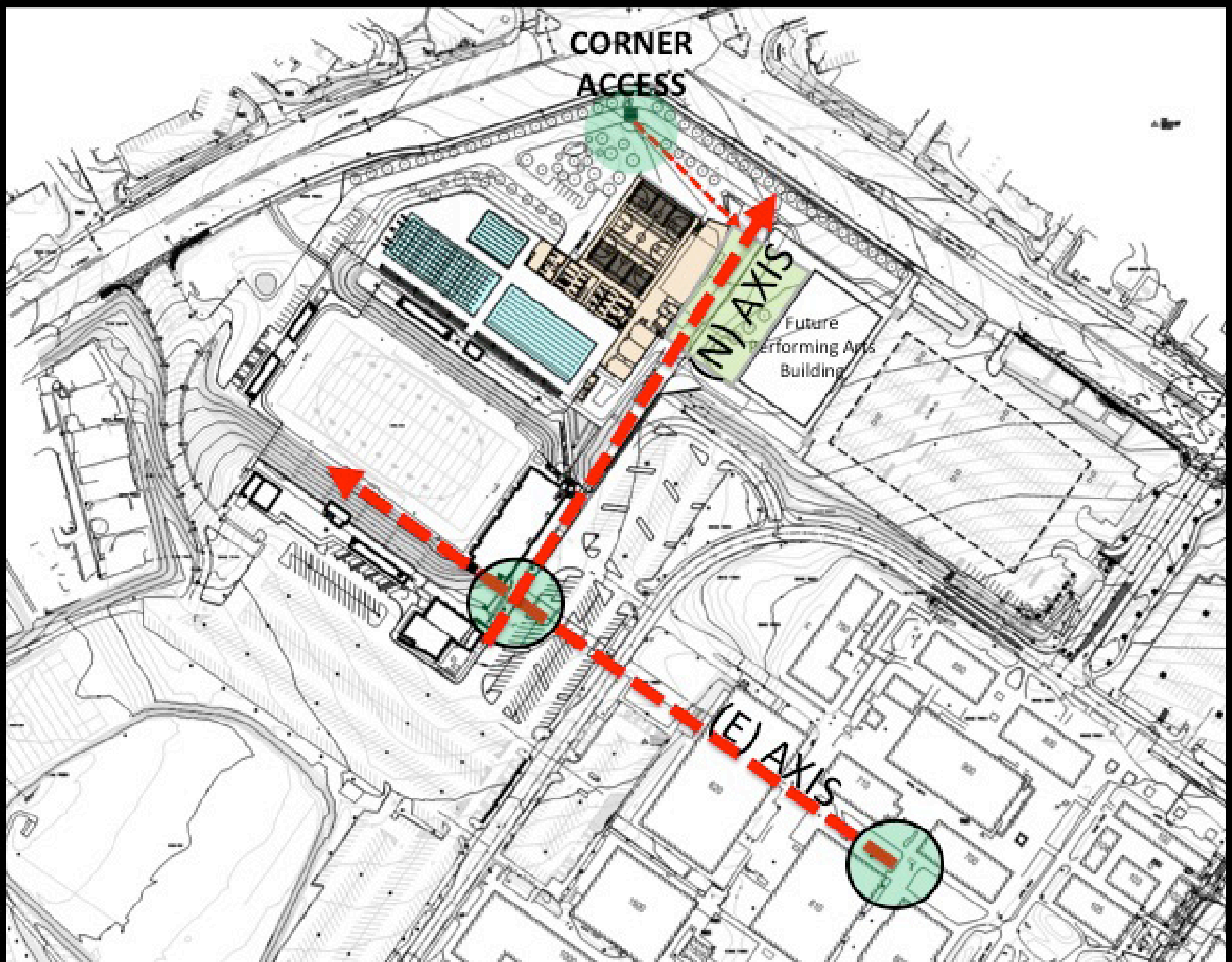

SITE DESIGN CONSIDERATIONS





SITE PLANNING CONCEPT

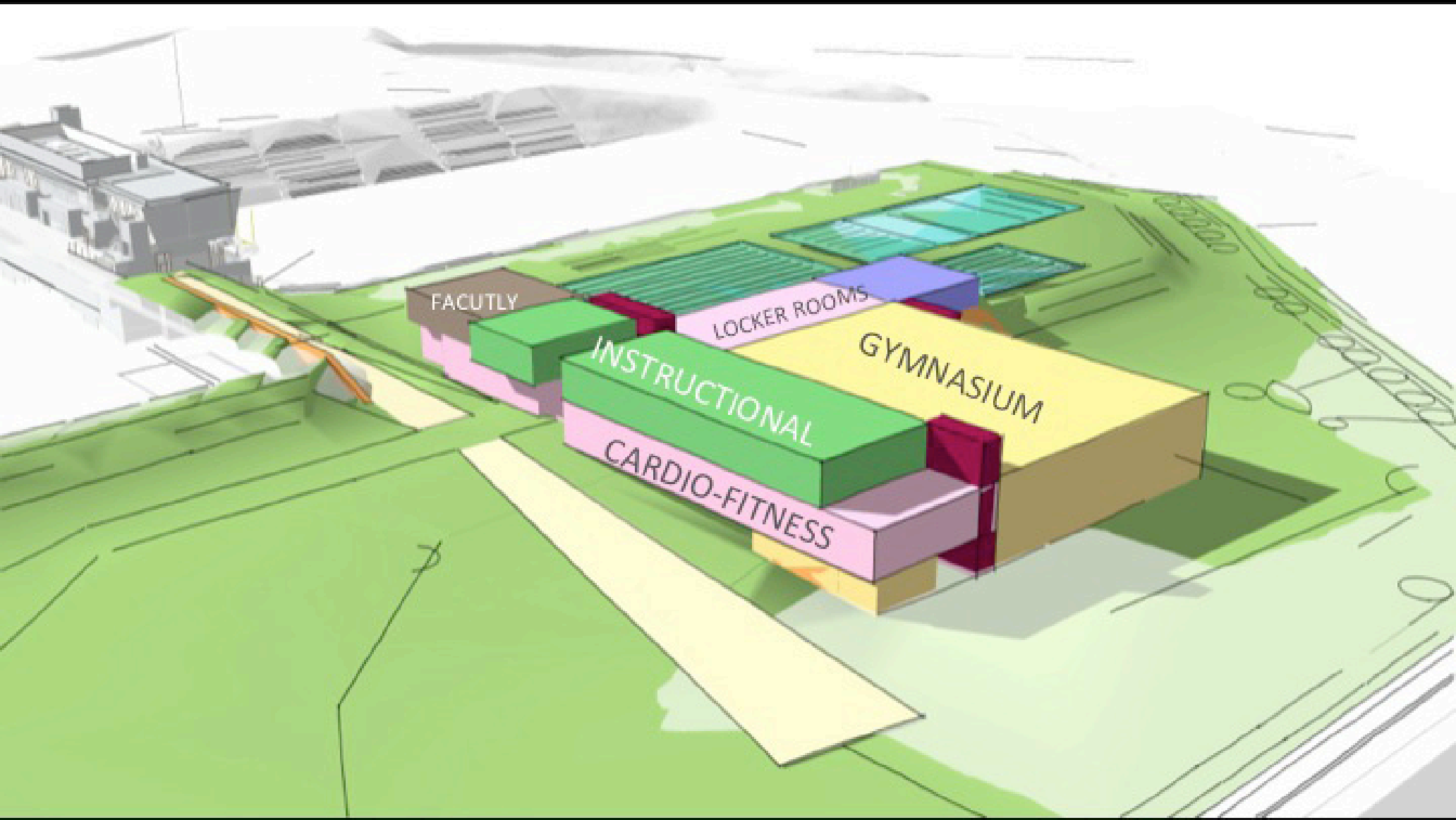

BUILDING MASSING



DESIGN GOALS

- “**BREAK DOWN**” THE **MASS** OF THE BUILDING THAT HAS INHERENTLY LARGE VOLUME SPACES
- SUGGEST **CLEAR AND DISTINCT** POINTS OF ENTRY
- DEVELOP A **HUMAN SCALED** DESIGN
- DESIGN AN **ICONIC AND MEMORABLE FACE OF CAMPUS**
- **INTEGRATED** INTO THE **CAMPUS CONTEXT**

CAMPUS CHARACTER

- FACETED ANGLES
- CANTED WALLS
- SHADE
- LANDSCAPE
- OUTDOOR PLACEMAKING

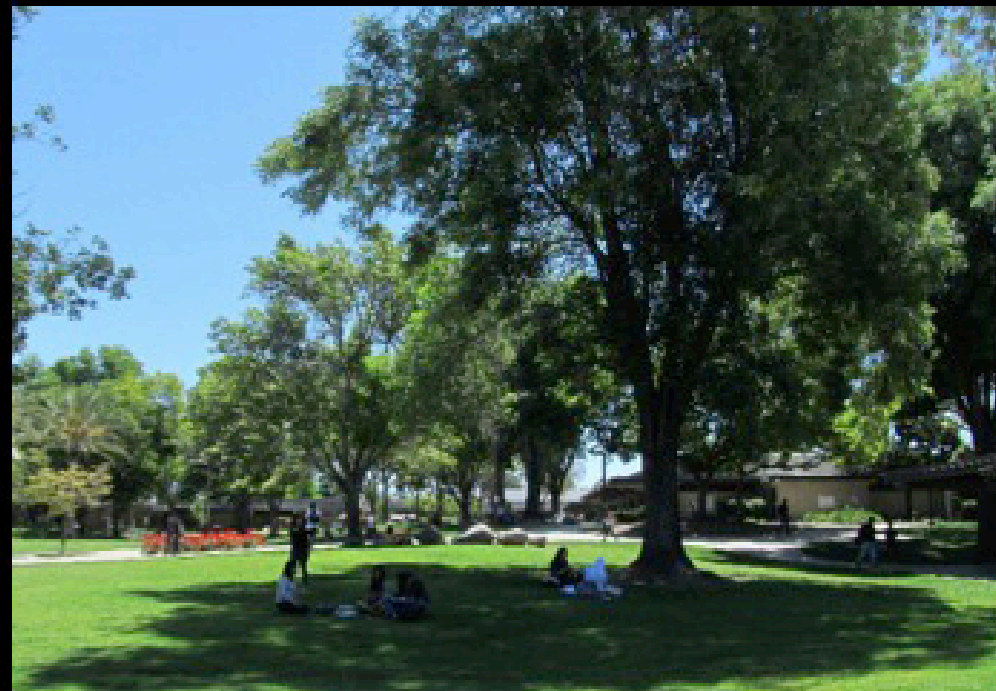

ARCHITECTURAL CONTEXT

- LIGHT & SHADOW
- TEXTURE
- SCALE
- RHYTHM
- PATTERN

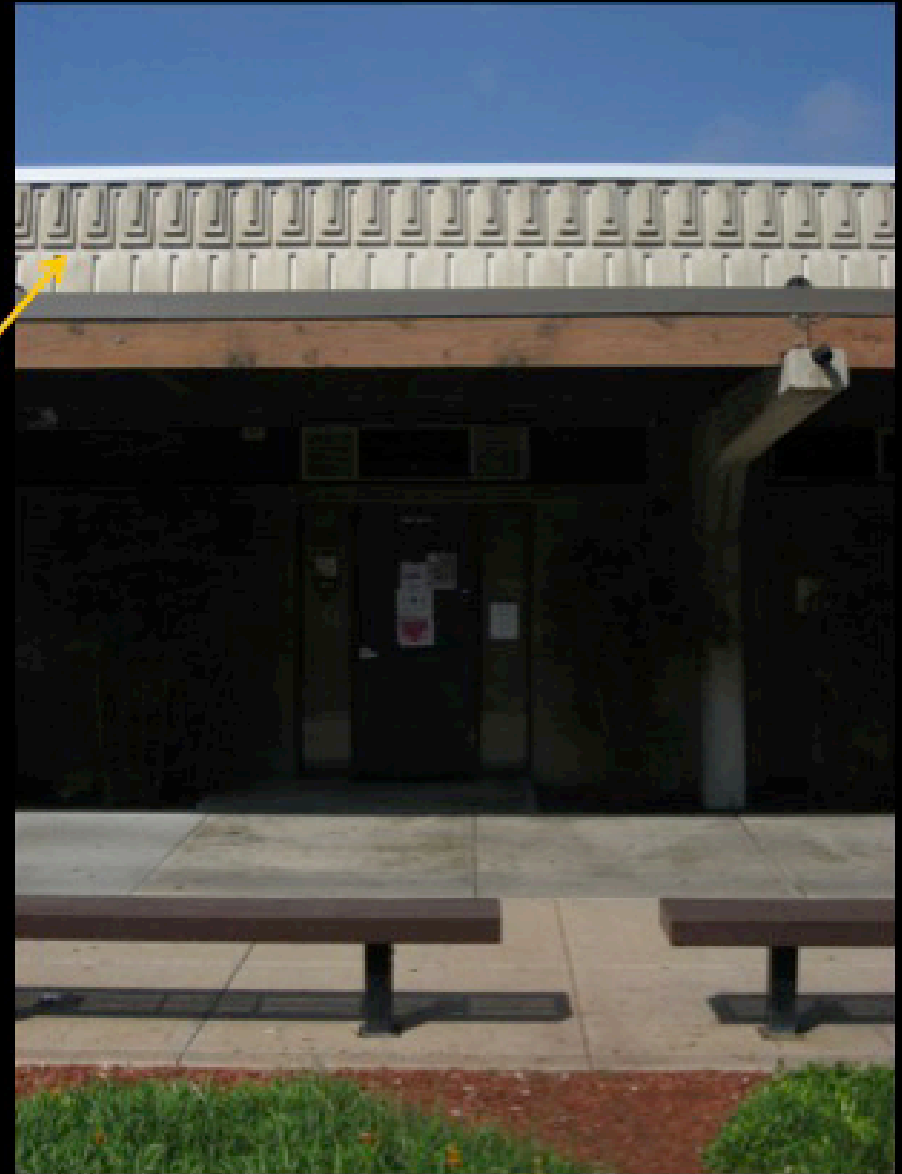
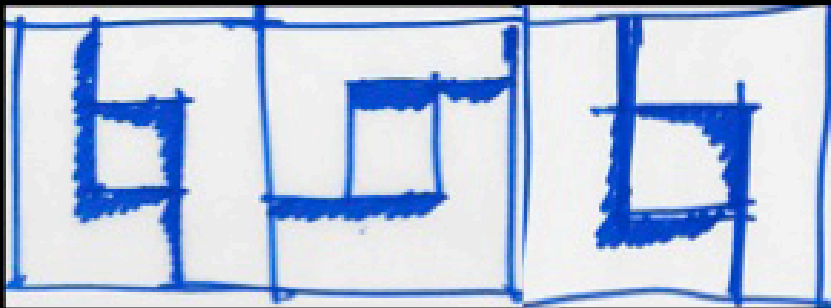

SITE CONTEXT



SITE CONTEXT

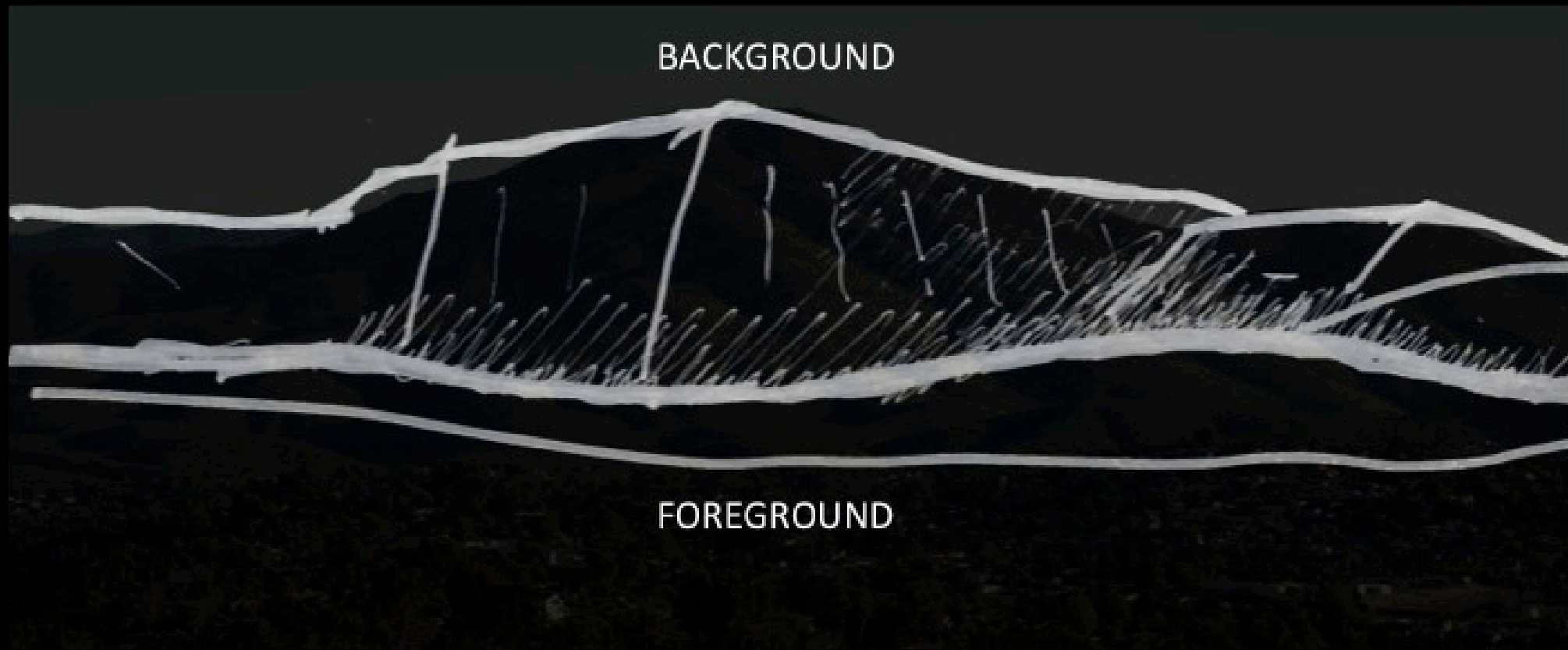

SITE CONTEXT





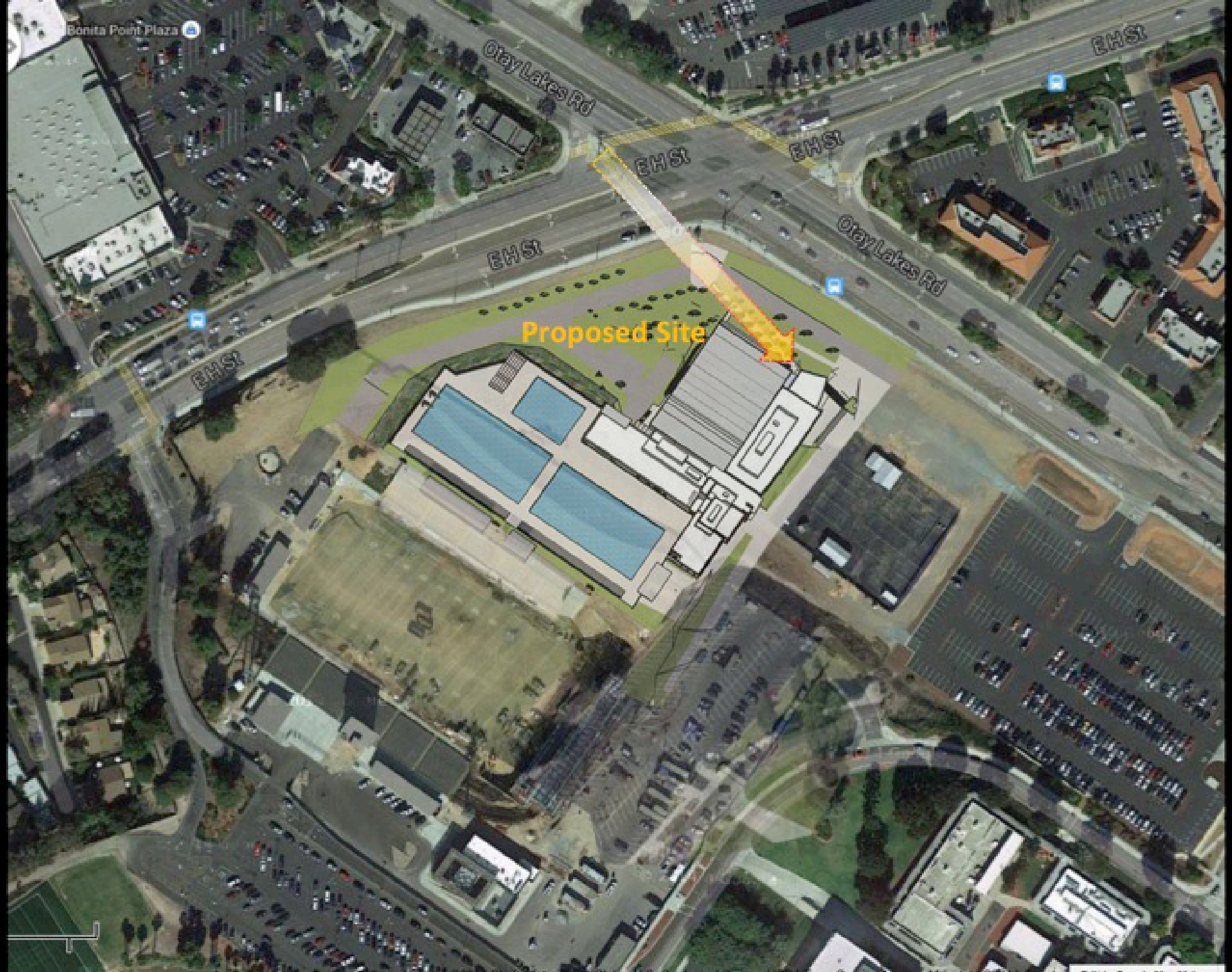

Bonita Point Plaza

Olay Lakes Rd

EHS St

EHS St

EHS St

Olay Lakes Rd

Proposed Site

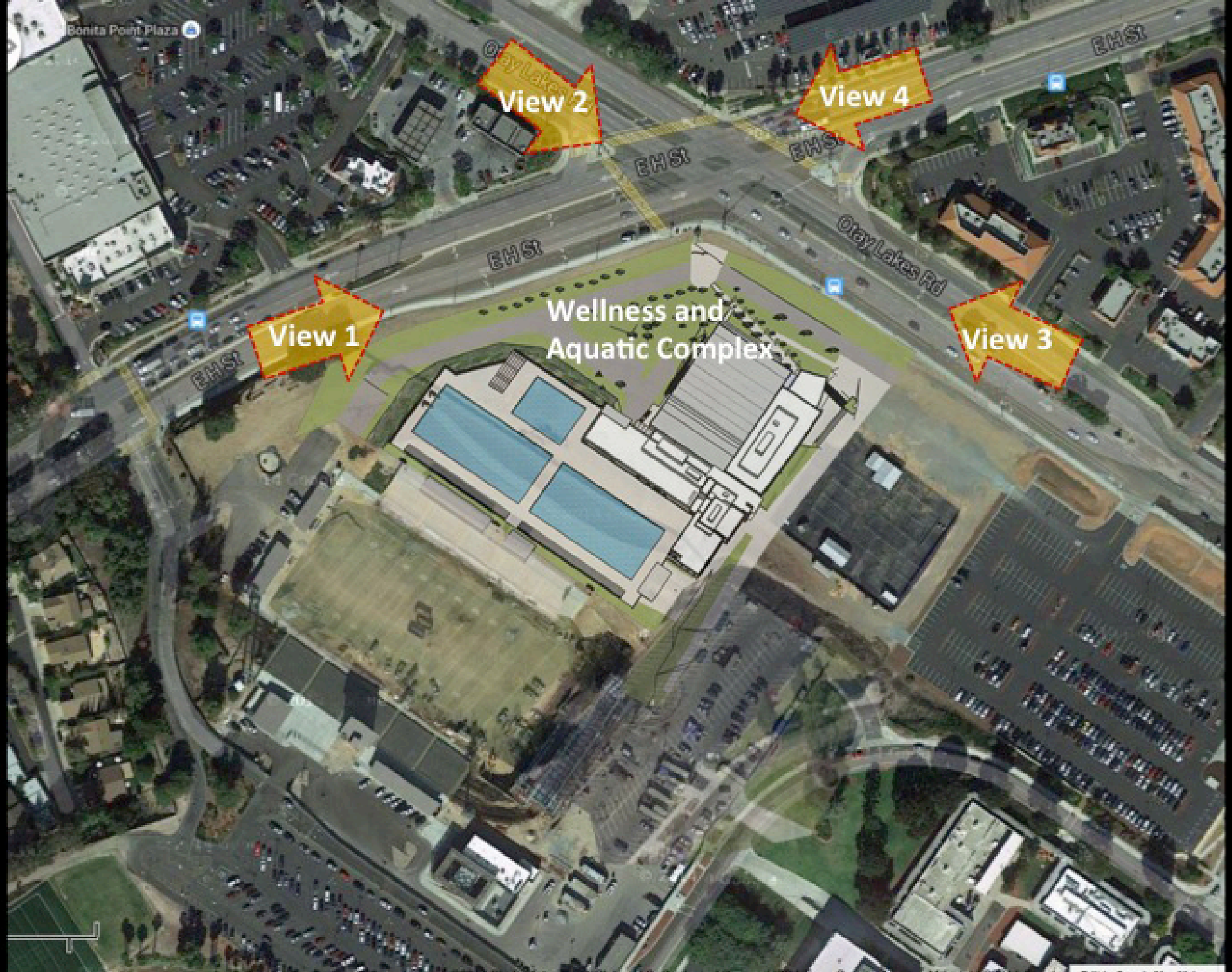

Bonita Point Plaza

View 2

View 4

View 1

Wellness and
Aquatic Complex

View 3

EHST

EHST

EHST

Otay Lakes Rd

EHST

Views



View 1 – E. H Street Looking East



Views

Otay Lakes Rd, Chula Vista, California, United States
Address is approximate



View 2 – Otay Lakes Road Looking South



Views



View 3 – E. H Street Looking West



View 4 – Otag Lake Looking Northwest



View 4 – Otag Lakes Road Looking Northwest



Elevations

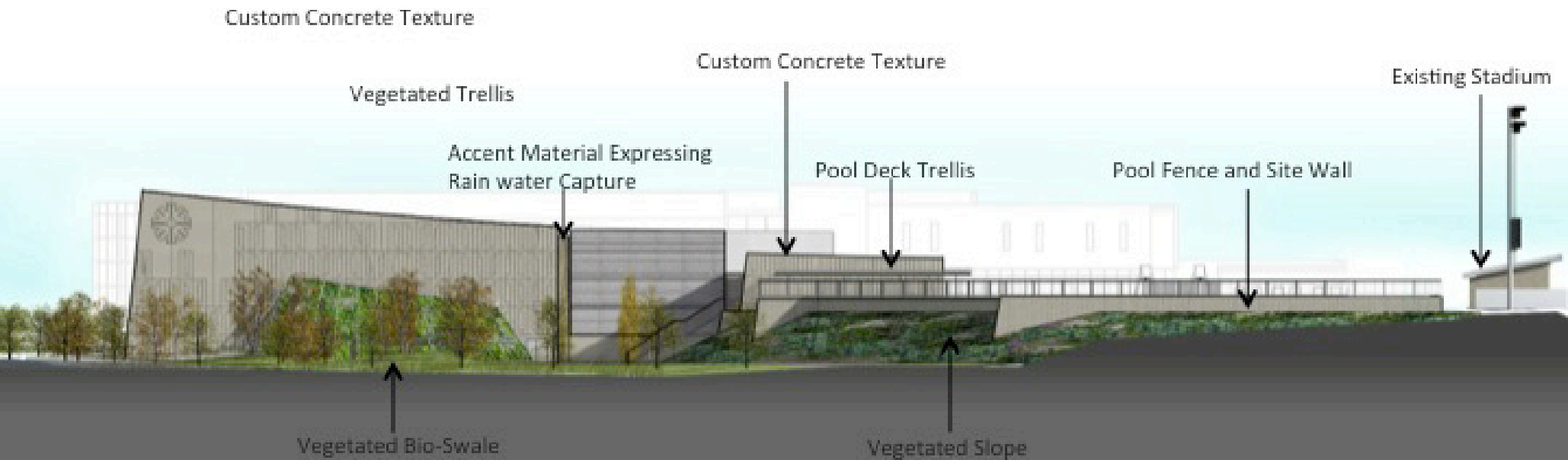

Northwest Elevation from East H Street

Elevations



Southeast Elevation from Campus



Northeast Elevation from Otay Lakes Road







WELLNESS AND AQUATIC COMPLEX

Program Summary

GYMNASIUM AND EVENT LOBBY	22,770 SF
ATHLETIC TEAM LOCKER ROOMS / SUPPORT	2,680 SF
STUDENT AND COMMUNITY LOCKER ROOMS / SUPPORT	4,370 SF
STUDENT AND COMMUNITY FITNESS / MULTI-PUPOSE	14,075 SF
INSTRUCTIONAL SPACE	7,800 SF
FACULTY SPACE	1,580 SF
AQUATICS	3,690 SF (2) 50 m POOL (1) 25 y POOL
<hr/>	
GROSS FLOOR AREA	75,250 SF

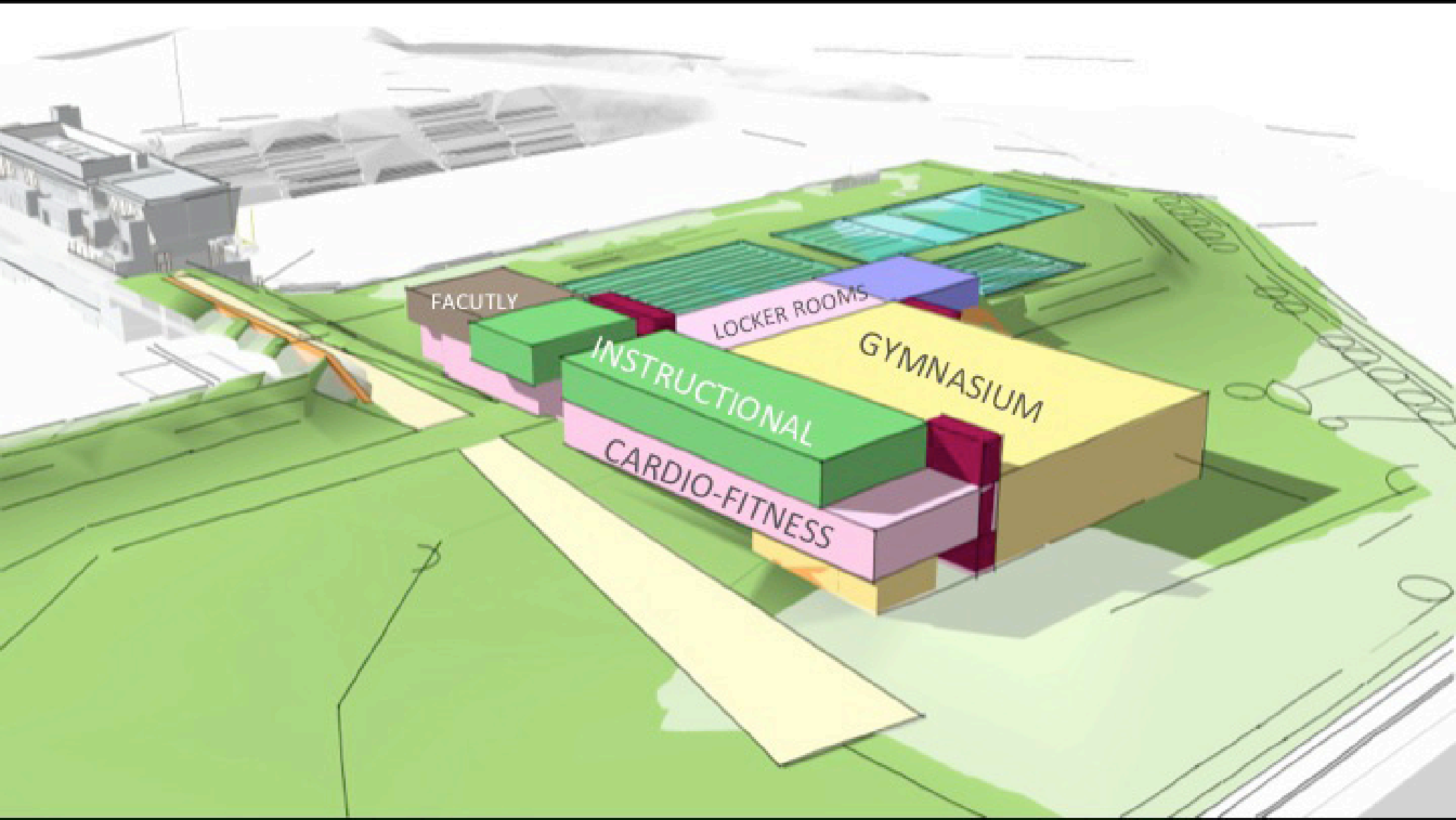

BUILDING MASSING

Level 1 – Floor plan

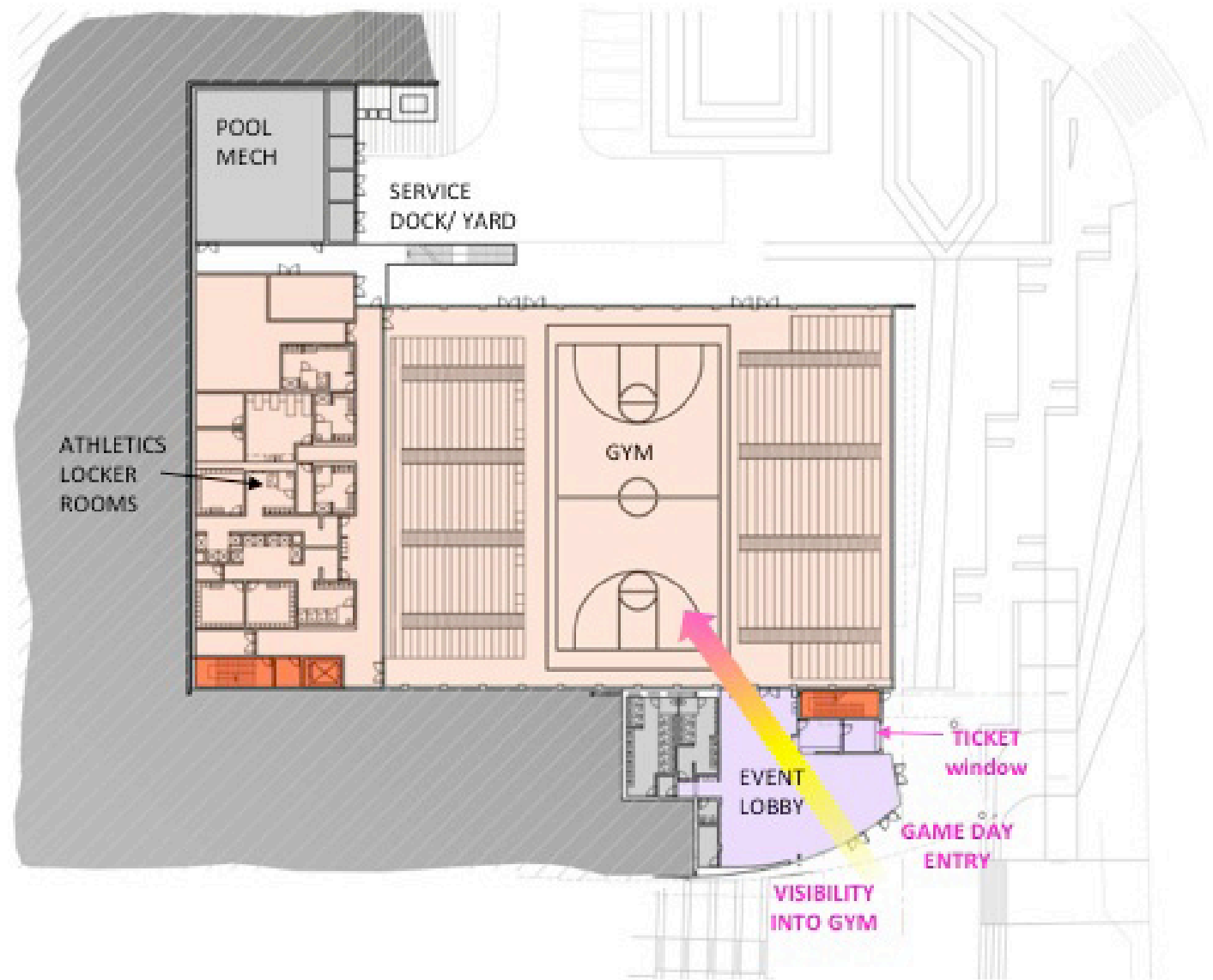

Level 2 – Floor plan

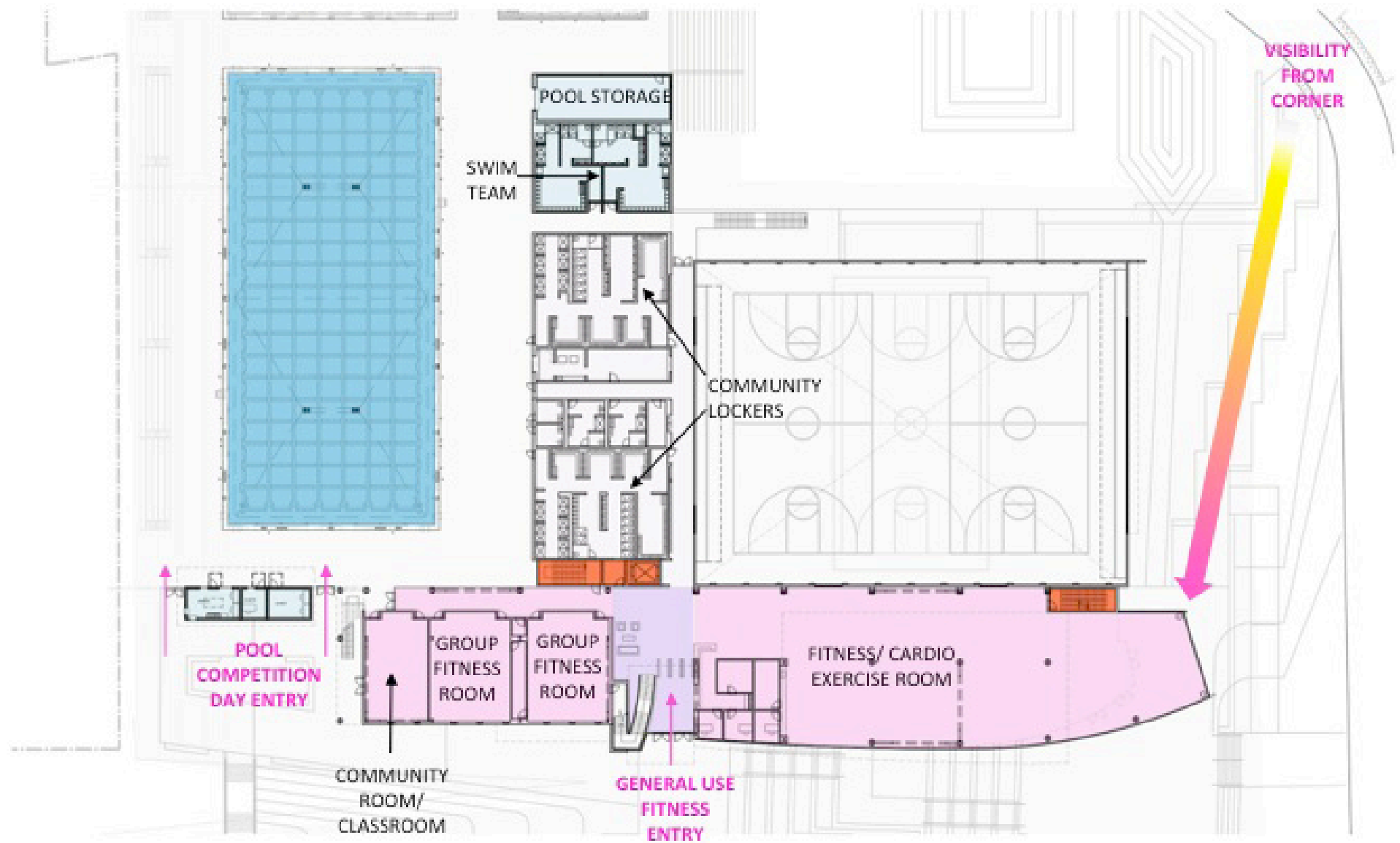

Level 3 – Floor plan

