

Project Overview

Current Status /Phase	Construction
Construction Type	New Construction
Gross Square Footage	11,000
Division of State Architect	04-119158
Construction Method	Design Bid Build
Project Life-Span	1318 Days

Project Financials

Funded By	Measure Z
Programmed Budget	\$30,387,791
Current Budget	\$42,321,769
Expenditures to Date	\$9,737,846

Project Teams

Architect	Gensler
Structural Engineer	Miyamoto International, Inc.
Civil Engineer	NV5 Engineering
Electrical Engineer	PS2 Inc.
Mechanical Engineer	PS2 Inc.
SWC Project Manager	Gaby Arana
General Contractor	PCL Construction
DSA Inspector	Blue Coast Consulting

Site Detail

Campus	Chula Vista (Main) Campus
Coordinates	32.637314, -116.998602

Project Schedule

Programming	Design and DSA Finish	Construction Finish	FFE & Move-In Finish
Spring 2019	Fall 2020	Spring 2024	Summer 2024

Project Insight

Southwestern College Landscape and Nursery Technology (LNT) Department is located in the South Bay Botanic Garden (SBBG) at the Chula Vista Campus. The Garden is an always evolving classroom and rich resource for teaching and learning about design, construction, maintenance, nursery production, and all kinds of landscape related professions.

Southwestern College has the opportunity to update and replace the existing LNT structures within the SBBG. This project has an overarching vision to recreate the LNT complex as a premier sustainable learning and teaching center that is integrated with the college campus as a whole and showcased as the rich resource that it is.

The programming outline for the project has placement of buildings, classrooms, laboratories, gardens spaces, and other elements within the SBBG.

Project Concept Rendering



Project Features

- Learning Core
- Main Entrance
- Bus Drop Off
- Visitor Parking
- Maintenance Yard

Project Site Plan

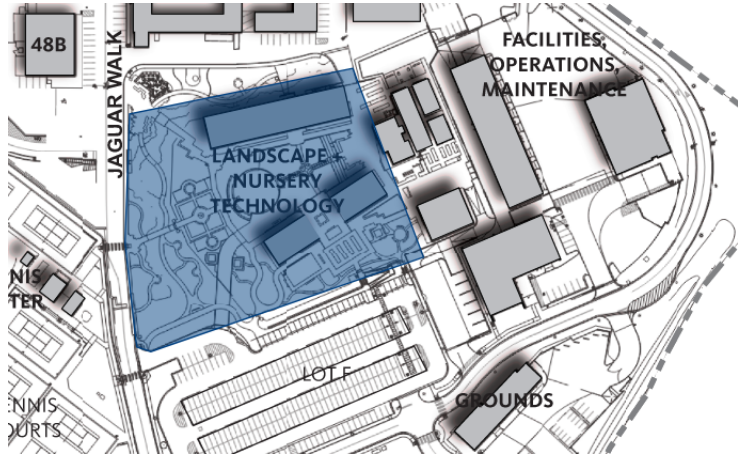

Project Budget Distribution

